

The information contained in this drawing is the sole property of CWS Coil Winding Specialists. Any reproduction in part or whole without written permission of CWS Coil Winding Specialists is prohibited.

REVISION HISTORY

REV	ECN	DESCRIPTION	SIGN & DATE			
			BY	DATE	CHK	DATE
B		PRODUCTION RELEASE	TDK	7/02/07	JLJU	7/02/07

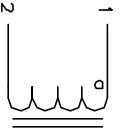

SCHEMATIC

7 BUILT TO ROHS COMPLIANCE AND LEAD FREE.

6 USING A PERMANENT MARKING METHOD MARK PART NUMBER AND REVISION, IF APPLICABLE IF NEEDED, WRAP INDUCTOR WITH GLASS TAPE

5 TO THE CORE MUST REST FLAT ON PCB. LEADS MUST BE TANGENT FLUSH WITH THE COIL EDGE, AS SHOWN (I.E. COIL REMOVE INSULATION AND TIN LEADS 0.5 INCH

4 WIND COILS EVENLY SPACED AROUND THE CORE CONSTRUCTION:

HI-POT TEST FOR WINDING TO CORE ISOLATION = 500VDC MIN  
 CURRENT RATING : 2.6 AMPS, 40 °C TEMP. RISE, NO AIR FLOW  
 DCR 160.0 MILLI-OHMS MAX.  
 DC BIASED = 2.6 AMPS, INDUCTANCE = 405 UH  
 DC BIASED = 3.8 AMPS, INDUCTANCE = 400 UH  
 INDUCTANCE = 500 UH +/-10% @ LOW DC BIAS, 1 KHz, 250mV  
 SPECIFICATIONS:

3 WIRE: UL RECOGNIZED 200°C RATED MAGNET WIRE  
 CWS BYTE-MARK OR OTHER APPROVED PART  
 CORE: COATED HIGH FLUX TOROIDAL CORE

2 RATING CLASS B (130°C MIN.) REQUIRED  
 MATERIAL: UL RECOGNIZED 94V-0 FOR FLAMMABILITY

NOTES: TOROIDAL POWER CHOKES. ALL DIMENSIONS IN INCHES  
 READ FROM BOTTOM UP.

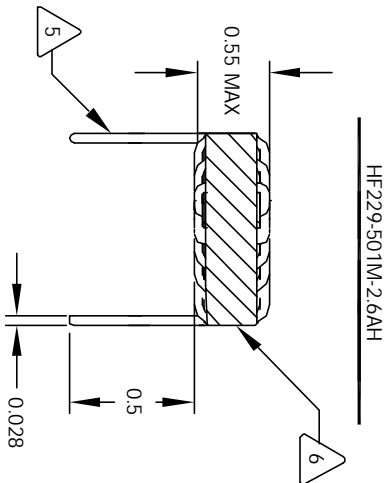

FRONT VIEW

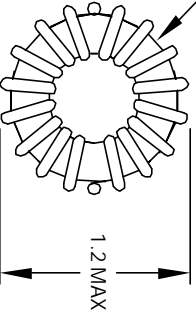

BOTTOM VIEW

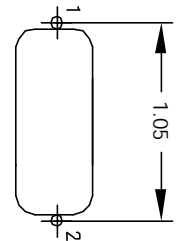

MOUNTING HOLES PATTERN

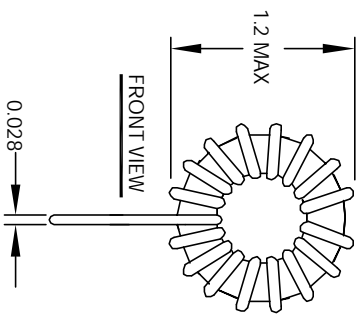

FRONT VIEW

SIDE VIEW

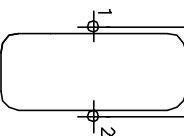

MOUNTING HOLES PATTERN

UNLESS OTHERWISE SPECIFIED	
DIMENSIONING AND TOLERANCE PER ANSI Y14.5M	ALL DIMENSIONS ARE IN INCHES AND (MILLIMETERS)
TOLERANCE INCHES: XXX=±.005 XX=±.015 TOLERANCE METRCS: XXX=±.127 XX=±.25	ANGLE PROJECTION
DO NOT SCALE DRAWINGS	

CODE IDENT	MFG. P/N	DESCRIPTION	ITEM NO.
AUTOCAD SOLIDWORKS SIGN	X	<b>COWS COM, INC</b> www.cowis.com	
DATE	DATE	CWS Coil Winding Specialist. 353 W. GROVE AVENUE ORANGE, CA. 92665	
DRAWN TDK	7/02/07	<b>Toroidal Power Chokes</b> HF229-501M-2.6A	
DESIGN JLJU	7/02/07		
ENGR. KSUM	7/02/07		
APPR. JLJU	7/02/07	SIZE: TMR. NO. B	REV B
SCALE 2=1		SHEET 1 OF 1	